

Technical Specifications

PRO+ Green-Facade

PRO+
the Facade System

PRO+ Facade Profile Green G01-AL

VERTICAL SECTION 1:5

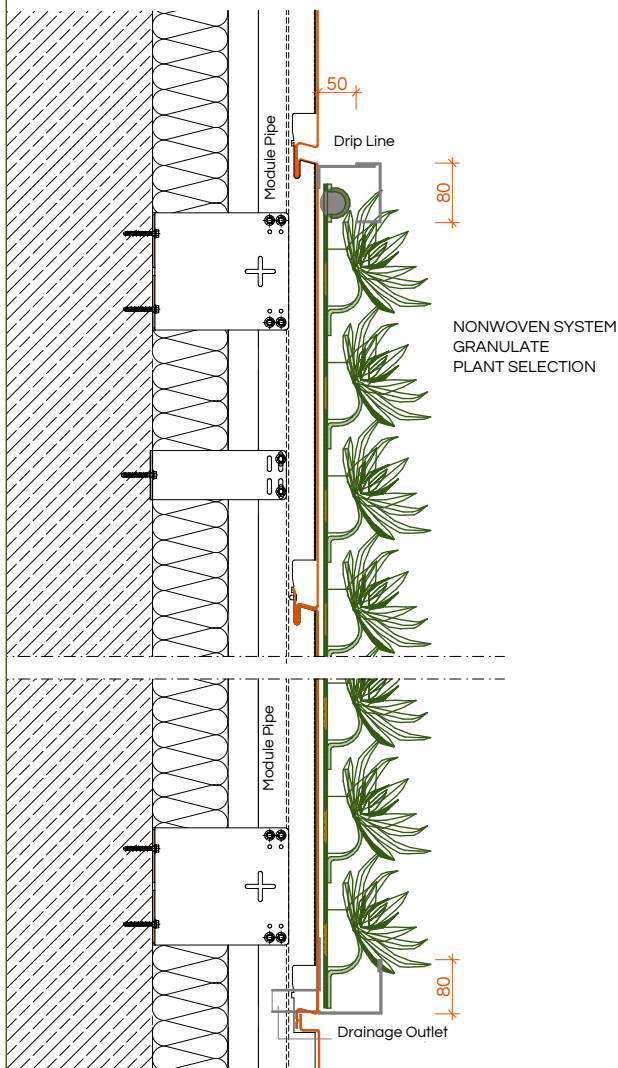

- + Profile: G01-AL
- + Material: AW3004 / AW3005 / AW5005
- + Weight: 3,57 kg/m
- + Length up to 7.000 mm in 200 mm increments (custom lengths on request)
- + Cover width: 500 mm
- + Joint width: 0 mm
- + Material thickness: Alu 1,5 mm
- + Installation direction: horizontal
- + Coating: PE
- + Water-saturated weight: <math>< 35 \text{ kg/m}^2</math>
- + Layer thickness: 25 my
- + UV resistance: D
- + Corrosion protection class: III
- + Inner side of the profile: RSL
- + Fire classification: A2 s1-d0 according to DIN EN 13501-1

HORIZONTAL SECTION 1:5

